

# IEC Terminal Boards

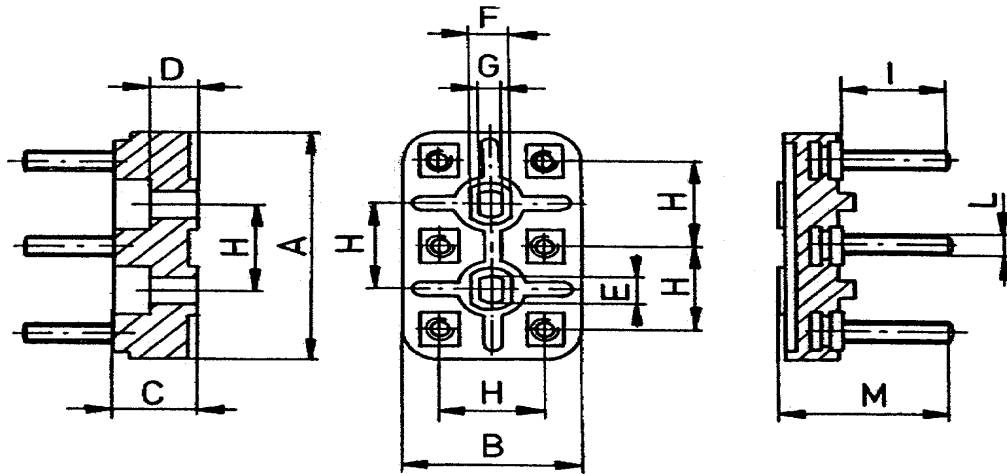

Dimensions											
Type	A	B	C	D	E	F	G	H	I	M	L
											Thread
50 32	50.0	32.0	12.5	7.0	6.0	8.0	5.5	18.0	11.5	23.0	M4
56 36	56.0	36.0	13.5	7.0	7.5	10.0	6.5	20.0	13.5	26.0	M5
70 45	70.0	45.0	17.0	10.0	12.5	10.0	6.5	25.0	16.0	32.0	M6
94 58	94.0	58.0	22.0	10.5	12.5	13.5	8.5	35.0	25.0	44.5	M8
115 70	115.0	70.0	23.5	11.5	18.0	16.5	10.5	44.0	28.0	47.5	M10
126 81	126.0	81.0	28.5	16.5	16.0	18.0	10.5	45.0	32.0	57.5	M12
146 92	146.0	92.0	34.5	17.5	21.0	18.0	11.0	54.0	37.0	68.5	M14
165 103	165.0	103.0	41.0	26.0	21.0	21.0	11.0	65.0	40.0	76.0	M16
240 150	240.0	150.0	53.0	36.0	21.0	21.0	11.0	90.0	52.0	95.0	M20

Board No.	amps	Wt. Gm.	Wt. Kg	Wt. Oz.	Wt. Lb.	List Price Each
M4	16	38.5		1.4		\$0.00
M5	25	56		2.0		\$0.00
M6	63	109.5		3.9		\$0.00
M8	100	163		5.7		\$0.00
M10	160	501.5	0.5	17.7	1.1	\$0.00
M12	250	807	0.8	28.5	1.78	\$0.00
M14	280	1261	1.3	44.5	2.78	\$0.00
M16	315	1705	1.7	60.1	3.76	\$0.00
M20	400	3713	3.7	131.0	8.18	\$0.00

All Terminal Boards are 20% glass reinforced Melamine for DIN 53 480

All Terminal Boards include nuts, washers and bridges



2320 Industrial Park Road - Van Buren, AR 72956  
 1-800-755-5571 479-474-5271 Fax 479-474-0193  
 E-mail: sales@alliede-p.com

